

DN20/0.75
MAINLINE ONLY

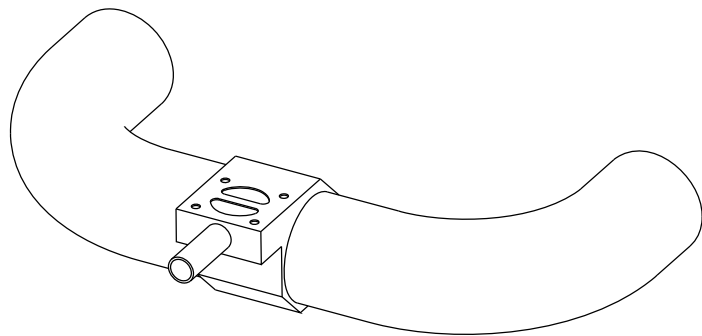

DN80/3.00 TO DN100/4.00
MAINLINE ONLY

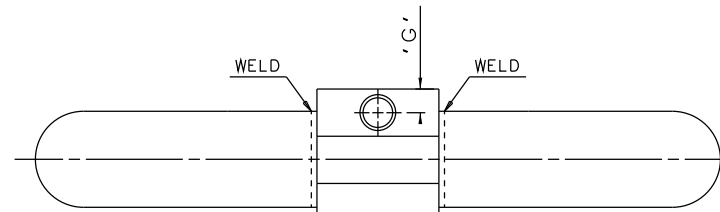
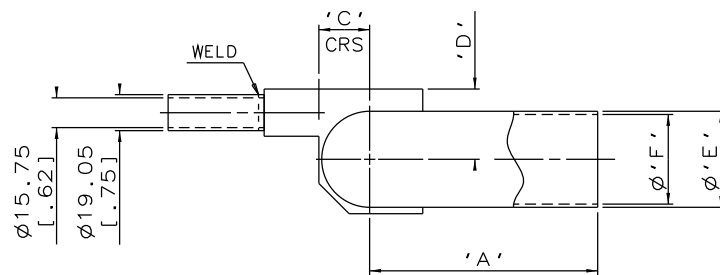
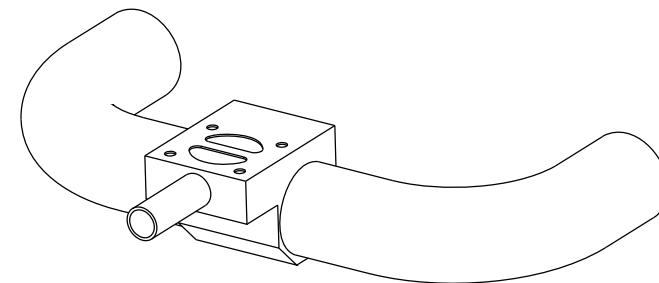
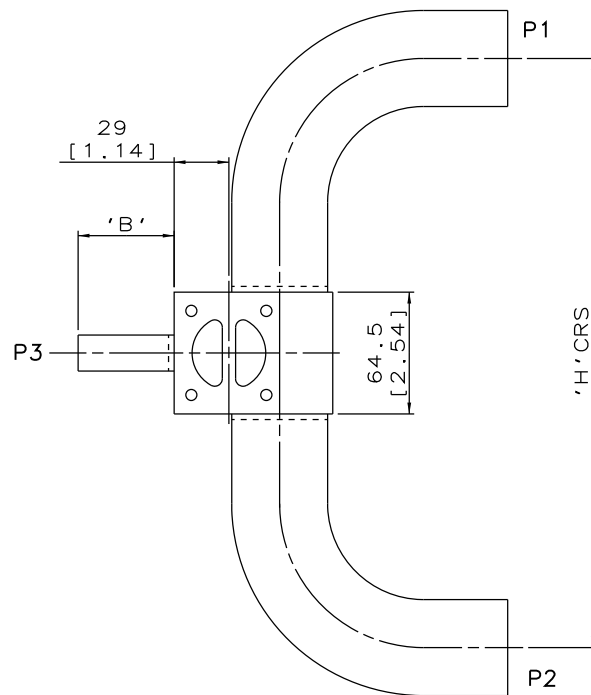

DN25/1.00 TO DN65/2.50
MAINLINE ONLY

The information on this sheet is Private and Confidential and is the property of Crane Process Flow Technologies Limited and must not be published directly or indirectly in any manner whatsoever without the written permission of the Company and must not be used in any way detrimental to their interests.
© Crane Process Flow Technologies

CRANE Process Flow Technologies
A Crane Co. Company

Saunders
The Science Inside

Title
SCHEDULE OF LEADING DIMENSIONS FOR DN20/0.75 WEIR POINT OF USE 'T' BODY WITH BUTT WELD OD TUBE ENDS

Drawn RI	Date 29.09.11	UNCONTROLLED IN HARD COPY FORMAT	
Checked RND	Date 08.03.12	UNCONTROLLED IN HARD COPY FORMAT	
First Angle Projection Method E	DO NOT SCALE	Drawing No. WEB-034	Issue. 2

MAINLINE SIZE		A		B		C		D		ϕE		ϕF		G		H		BODY WEIGHT
mm	inch	mm	inch	mm	inch	mm	inch	mm	inch	mm	inch	mm	inch	mm	inch	mm	inch	Kgs
DN20	0.75	76.2	3.00	50.8	2.00	10.9	0.43	20.0	0.79	19.05	0.75	15.75	0.62	12.5	0.49	222.9	8.78	0.9
DN25	1.00	76.2	3.00	50.8	2.00	14.9	0.59	26.0	1.02	25.4	1.00	22.1	0.87	12.5	0.49	222.9	8.78	1.1
DN40	1.50	95.3	3.75	50.8	2.00	20.5	0.81	32.0	1.26	38.1	1.50	34.8	1.37	12.5	0.49	261.1	10.28	1.4
DN50	2.00	120.7	4.75	50.8	2.00	26.9	1.06	37.2	1.46	50.8	2.00	47.5	1.87	12.5	0.49	311.9	12.28	2.0
DN65	2.50	139.8	5.50	50.8	2.00	33.6	1.32	42.5	1.67	63.5	2.50	60.2	2.37	12.5	0.49	350.1	13.78	2.5
DN80	3.00	158.8	6.25	50.8	2.00	39.5	1.56	46.2	1.82	76.2	3.00	72.9	2.87	12.5	0.49	402.1	15.83	2.9
DN100	4.00	203.2	8.00	50.8	2.00	52.3	2.06	58.2	2.29	101.6	4.00	97.38	3.83	12.5	0.49	490.9	19.33	5.4

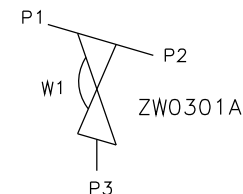

ORIENTATION AS PER P&ID DIAGRAM FOR OPTIMUM DRAINABILITY.

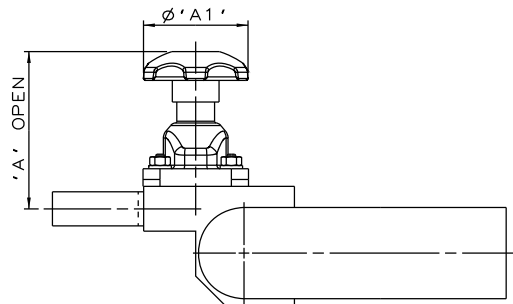

SS NON SEALED
BONNET ASSEMBLY

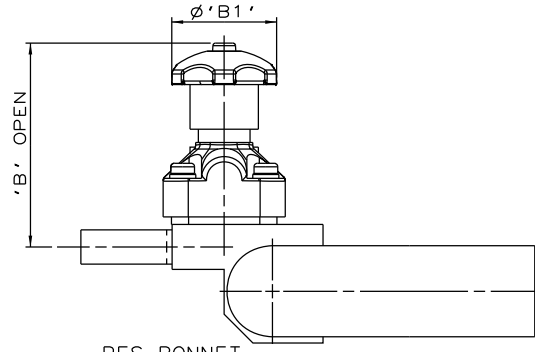

PES BONNET
ASSEMBLY

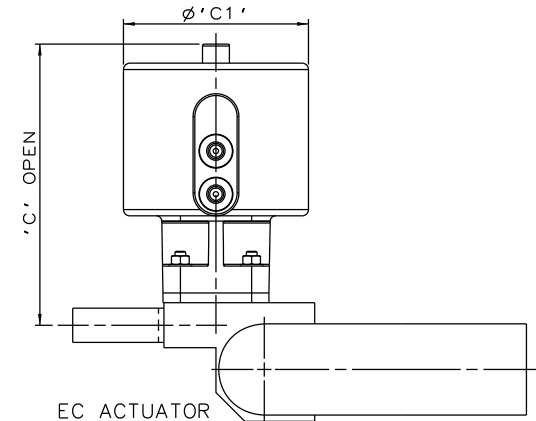

EC ACTUATOR
(ALL MODES)

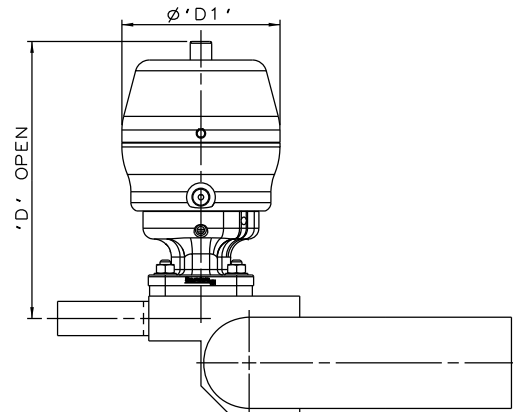

*S360 ACTUATOR

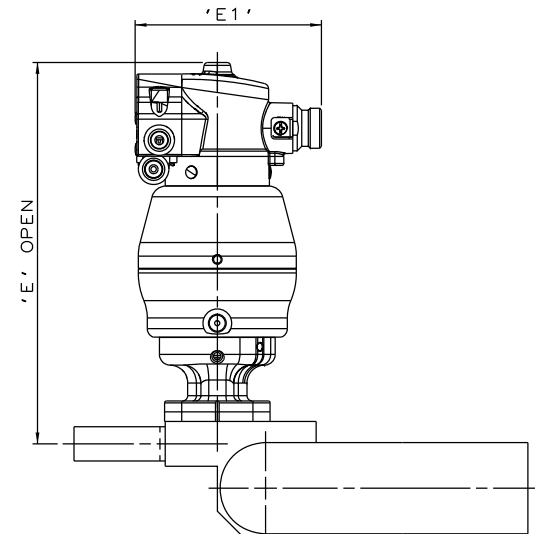

*S360 ACTUATOR
WITH M-VUE SENSOR

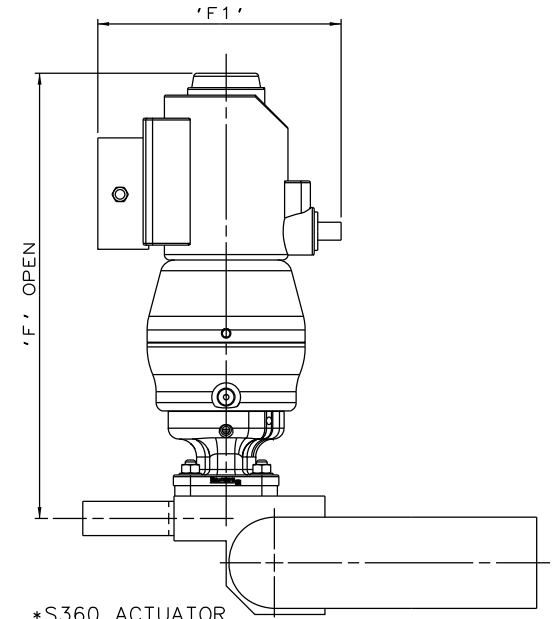

*S360 ACTUATOR
WITH I-VUE SENSOR

The information on this sheet is Private and Confidential and is the property of Crane Process Flow Technologies Limited and must not be published directly or indirectly in any manner whatsoever without the written permission of the Company and must not be used in any way detrimental to their interests.
© Crane Process Flow Technologies

CRANE	Process Flow Technologies A Crane Co. Company	Saunders The Science Inside
--------------	--	---------------------------------------

Title
SCHEDULE OF LEADING DIMENSIONS FOR DN20/0.75 WEIR
'T'BODY (DN20/0.75 BRANCH) WITH BUTT WELD OD TUBE ENDS,
FITTED WITH TOPWORKS OPTIONS

Drawn	R1	Date	28.06.16	UNCONTROLLED IN HARD COPY FORMAT
Checked	RND	Date	28.06.16	
First Angle Projection Method E		DO NOT SCALE	Drawing No. WEB-034-ASSY	Issue. 1

* DIMENSIONS SHOW MAXIMUM ENVELOPE FOR ALL MODES

BRANCH SIZE	A		A1		B		B1		C		C1		D		D1		E		E1		F		F1		
	mm	inch	mm	inch	mm	inch	mm	inch	mm	inch	mm	inch	mm	inch	mm	inch	mm	inch	mm	inch	mm	inch	mm	inch	
DN20	0.75	87.5	3.44	62.0	2.44	113.5	4.47	62.0	2.44	156.5	6.16	103.0	4.05	163.5	6.44	98.0	3.87	224.5	8.84	103.8	4.09	259.5	10.22	136.0	5.35